

POWER TOUCH GOLD RAZOR

IMPORTANT INFORMATION BEFORE USE

- We recommend not to let children use this product.
- Always make sure you have dry hands before turning on the product.
- The unit contains a sharp blade. Be careful and avoid the contact of the blade with the skin during use and maintenance.
- Do not immerse or use the product in water or in any other liquid; do not use it if you have spots.

SECURITY MEASURES

- Turn off the device when not in use and before cleaning or changing accessories.
- Keep the appliance out of the reach of children. Tight control is required if used when there are children nearby.
- This appliance can be used by children from 8 years of age and people with physical, sensory or mental disabilities or lack of experience and knowledge if supervised or train them on how to use the device safely and explain the dangers it involves. Children must not play with the device. Cleaning and maintenance should not be done by children without supervision.
- Keep the appliance dry and away from the areas where it can splash. Never immerse it in water.
- Keep it away from heat, sharp objects or anything that can damage it. Make sure to keep all grates, crevices, etc. clean and free of residues. of ventilation, and not to have external objects inside them.
Do not put the appliance into operation if it is damaged or does not work well.
Non mettere in funzione l'elettrodomestico se è danneggiato o non funziona bene.
- If the shaver is not used for a long time, remove the batteries to avoid possible leaks.
- Always use your razor exclusively as described in this manual.

GET TO KNOW YOUR DEVICE

1. Cover
2. On / Off Switch
3. Lama
4. Body
5. Battery Cover
6. Brush
7. Blade Cover



SPECIFICATIONS

Model number	KKNT009
Battery	1X1,5V LR06 / AA (not included)
Dimensions	13 (long) x 2,7 (wide) x 2,9 (high) cm
Net Weigth	46g

POWER TOUCH GOLD RAZOR

HOW TO CHANGE THE BATTERY

This device is designed to be used with 1 AA (1.5 V) battery (not included). If the shaver motor starts running slower, or less efficiently, change the battery. To change the battery, turn the bottom cover as shown in the following image. Insert the AA battery, respecting the polarity and replace the bottom cover.

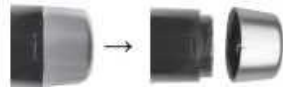

To change the battery

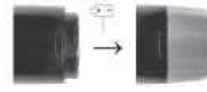

To insert the battery

Dispose of used batteries properly, use local collection and recycling facilities when available.

Nota:

- The batteries must be inserted respecting the polarity.
- Used batteries must be immediately removed and discarded according to the manufacturer's recommendations.
- Remove the batteries when the device is not used for a long time.
- Do not short circuit the battery terminals or the contacts inside the compartment.

OPERATION

1. Remove the lid.
2. Turn on the shaver, you will hear the motor running.
3. Keep the razor close to the nostril or ear.
4. Cut only the hair that comes out of the ear or nostril.
5. Disconnect the device after using it and clean the brush head.

CLEAN THE RAZOR

1. The device must be turned off to clean it.
2. Remove the silver blade cover as shown in the following image to remove the blade (WARNING: YOU MUST BE VERY CAREFUL WHEN HANDLING IT, BECAUSE THE BLADE IS VERY SHARP).

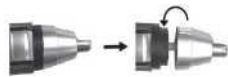

3. Brush the blade and the adjacent area with the cleaning brush.
4. Assemble the razor again by repeating the process in the reverse order.
5. Clean the body with a soft dry cloth.
6. Do not use any detergent, solvent, or strong or abrasive cleaning product. Never immerse it in water.

DATA PROTECTION

Pursuant to the provisions of the Organic Law 15/1999 of December on the Protection of Personal Data, the EHS customer can at any time exercise the rights of access, rectification, cancellation and opposition, communicating it in writing to Carretera Villaverde in Vallecas n ° 265 Hormigueras building, naves 1-4, 28031 Madrid (España).

WAIVER DOCUMENT

In case you are not satisfied with the purchased product, you can return it by certified mail within a maximum of 15 days, counted from the date of delivery of the product in your home.

I. Consumer data (please fill in the following data):

Mr./Mrs....., with NIF n °
....., I exercise my right of renunciation,
requesting the return of the money paid by registered check..

II. Company Information:

The product must be sent to EUROPEAN HOME SHOPPING, S.L., with CIF B-80339823, at the address Carretera de Villaverde in Vallecas n ° 265 Edificio Hormigueras, naves 1-4, 28031 Madrid or to the PO Box 38051,28080 Madrid.

III. Requirements for exercising the right of renunciation:

You must send the product within the maximum period of 15 days from the date of delivery of the product to your home.

The product must be returned in its original packaging.

Once we have received the product in our warehouse, we will send you a nominal check equal to the amount of the product within the approximate period of 30 days.

IV. Further information

For further information, you can visit the web page www.ehs.tv, call the customer service number +34 902 333 243 or send an e-mail to att.cliente@ehs.tv

Customer support - EHS TV

WEEE mark (Register of electrical and electronic equipment)

The residues of electrical products must not be thrown into the household garbage. Please recycle when there are special centers. Consult the local authorities, they will show you where to recycle.



www.ehs.tv

Distributed in Spain by:

European Home Shopping

Postal Code 38051,28080, Madrid, España.

Customer Service Ph:902 333 243

Made in China

THANK YOU FOR YOUR PURCHASE

Power Touch[™] **GOLD EDITION**

Razor for wet and dry use
With nose / ear razor



USER INSTRUCTION GUIDE

CAUTION

SAFETY INSTRUCTIONS

NOTE: READ ALL THE INSTRUCTIONS BEFORE USE.

1. As with all electrical devices, use the razor with caution.
2. If you used the razor in the shower or bathtub, be sure to rinse it properly and store it in a safe place.
3. Keep it away from heating devices or hot surfaces.
4. Never attempt to operate the shaver if it has fallen into water or a hard surface, or while the battery compartment is open.
5. Store the razor in a dry and cool place. Do not expose the razor to extreme temperatures, for example carrying it in the car during the summer.
6. After placing the batteries, make sure that the compartment is closed correctly and securely.
7. Make sure to dry your hands before placing or changing batteries.
8. Always make sure the shaver IS IN THE OFF POSITION BEFORE placing or changing the batteries.

POWER TOUCH GOLD RAZOR

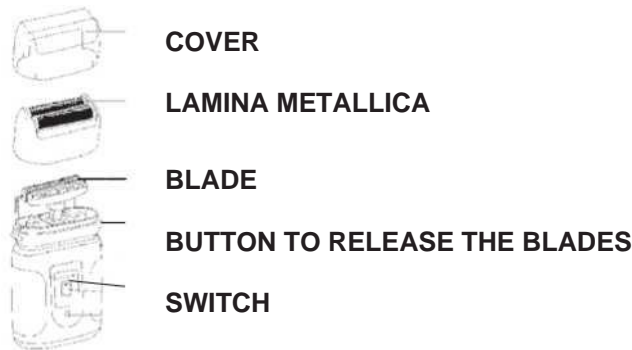

TO SHAVE

If you have never used an electric razor, it will take some time for your skin to adapt to this razor. At the beginning it is possible that the skin becomes irritated and that it does not get a good shave as you would like. It is normal and the situation will improve over time. Wait two weeks to get used to the razor.

1. Remove the transparent cover from the shaver and switch it on.
2. Place the razor on the edge of the beard until it gently touches the skin, making sure the blades are in contact with the skin.
3. Stretch the skin with your free hand while sliding the razor continuously towards the first and second sides with short movements in the opposite direction to the growth of the beard. Keep shaving in this way until you are satisfied with the result.
4. NOTE: Do not apply too much pressure to shave. This could pinch the skin or pull fluff with the blades, which could damage or ruin them.
5. Clean the razor after use.
6. After you are finished shaving, place the shaver in the OFF position and put the protective cover back on.

CUTS

The razor has a wide sliding down trimmer, ideal for cutting mustache, sideburns or beards.

1. Slide the razor upwards to fully extend it.
2. Move the switch to the ON position; now you are ready to use the razor.
3. Approach the razor with the brush head down and the razor blade at right angles to your face.
4. Apply gentle downward movements. Keep cutting this way until you are satisfied with the result.
5. Move the switch to the OFF position and remove the razor by sliding it downwards.



MAINTENANCE

CLEANING THE RAZOR

1. The razor blades accumulate cuttings of facial hair during use. For optimal performance, clean these parts after each use.
2. Since this razor is suitable for wet and dry use, you can choose to use the brush provided with the device or simply rinse the razor blades under a jet of water.
3. NOTE: When rinsing the razor with water, ALWAYS MAKE SURE that the battery compartment is closed securely and that the appliance is in the OFF position.
4. To clean the blades, remove the case that contains them by pressing the buttons on each side of the razor. Now you can remove the case. Simply remove all the rest of the hair and replace the case safely.

CLEANING THE RAZOR

1. For optimum performance, clean the remains of facial hair that remain between the teeth of the razor before or after each use.
2. If you want to cut a large amount of hair at once, clean the razor during the process.

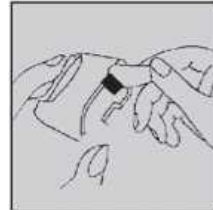
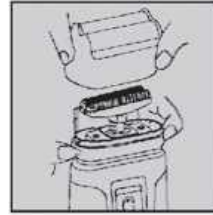

TO KEEP IN MIND

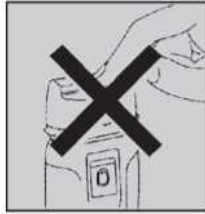

The blades are pressure sensitive. **DO NOT** press or subject them to direct pressure.



DO NOT try to remove the blade case with a screwdriver. Use the buttons on each side of the razor for this purpose.